

Rack 47U CAMERA TEHNICA PENTRU TELECOMUNICATII PARTER

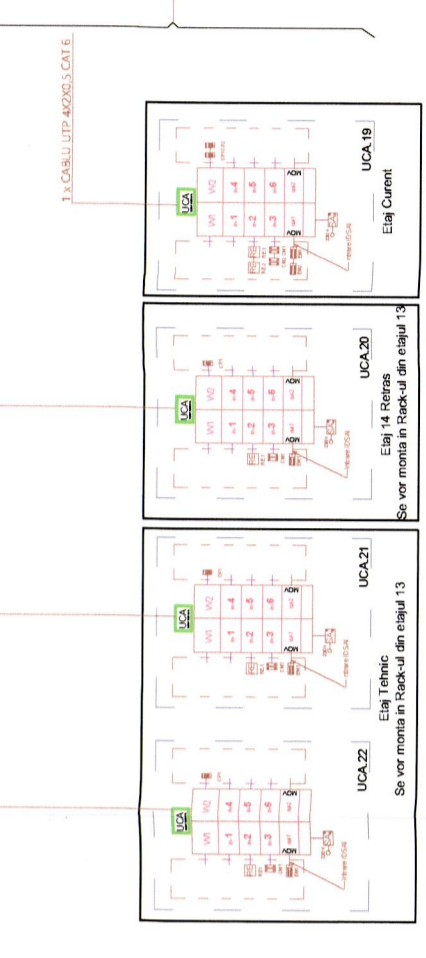
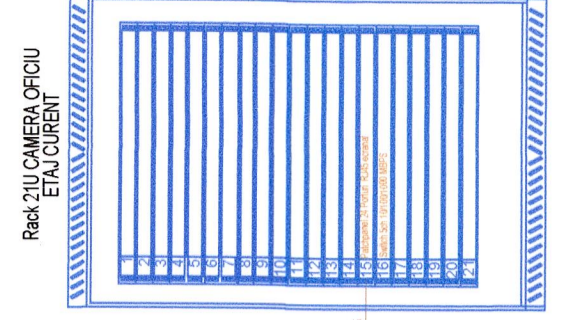
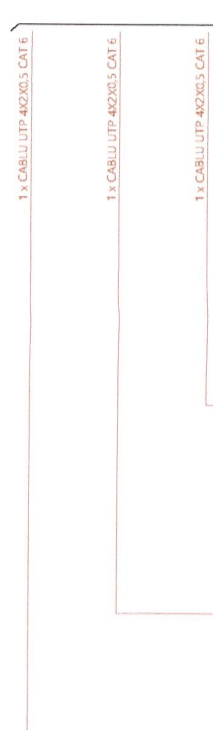
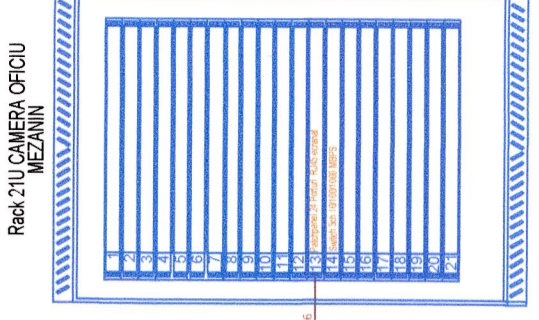
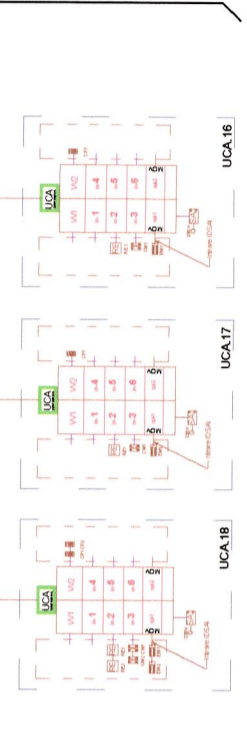
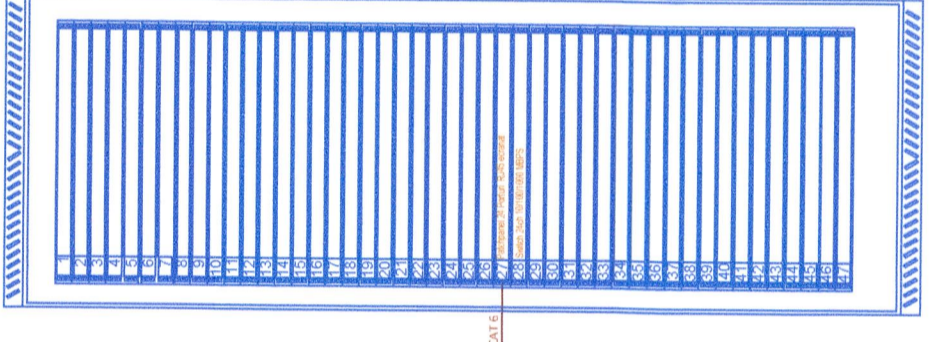

LEGENDA CONTROL ACCES

- UCA** Unitate control acces
- Clotitor de proximitate
- RE** Buton "Request to Exit"
- Dispozitiv electromagnet
- Contact magnetic
- Sursa de alimentare
- Cablu UTP CAT 6 firehalogen

PRINCIPALII INDICATORI AI CONSTRUC TIILOR:
 Categori de importan tã: C (nominalã) conform HG nr. 766/1997;
 Clasã de importan tã (categoriã de importan tã specificã): III conform P100-1992;
 Gradul de rezisten tã la foc:
 Compartiment 1 corp 1 Hotel cladire inãlta: GRF I - risc MIC de incendiu
 Compartiment 2 corp restaurant + piscinã: GRF III - risc MIC de incendiu
 Compartiment 3 stãie pompe incendiu: GRF II - risc MIC de incendiu
 Compartiment 4 posturi tãto: GRF II - risc MILOCIU de incendiu

Acest document este proprietate intelectualã a s.c. Wire Project Solutions s.r.l. Reproducerea sau difuzarea sunt interzise fara acordul scris din partea s.c. Wire Project Solutions s.r.l. This document copyright © is owned by s.c. Wire Project Solutions s.r.l. No parts of this document may be reproduced or transmitted without the written permission of s.c. Wire Project Solutions s.r.l.

VERIFICATOR / EXPERT
 Beneficiar:

Titlu proiect
 Nr. plansã: **CS12**
 Modernizarea și reabilitarea energeticã a Centrului de progrãtiri și refacere/recuperare a capacitãții de muncã Pãna - Saturn, Mangalia, județul Constan tã Amplasament: Loc. Pãna - Saturn, nr. 2-2D, NC102305, NC102304, NC102303, NC102228

Instalatã
 INSTALATIILE ELECTRICE CURENTEI SLABI
 Schema Bloc Control Acces
 CORP C1

Proiectant general / Beneficiar:
NEO STRUCUTURAL ENGINEERING SRL
 SC NEO STRUCTURAL ENGINEERING SRL
 Structurãl, ingineria, proiectãri, proiectãri de arhitecturã, proiectãri de structurã civilã și industriale
 Proiectant instalatã: SC WIRE PROJECT SOLUTIONS SRL
 Pãna - Saturn, Mangalia, județul Constan tã, nr. 2-2D, NC102305, NC102304, NC102303, NC102228
 Licen tã activã nr. AB2102.12.2018
 Licen tã activã nr. AB2102.12.2018
 ANE: 102255.02.2018

Proiect nr.: 03/2025
SEF PROIECT: Ing. Ștefan Mihai BURCU
COORDONATOR INSTALATI: Ing. Elvis TARLEA
PROIECTAT: Ing. Amin JABAR
DESEINAT: Ing. Amin JABAR

Scara: PT-DE
Faza:

SEMNA TURA
 Ing. Amin JABAR
 Ing. Amin JABAR
 Ing. Amin JABAR

Data: Aprilie 2025

