

Vedere de jos 1:20

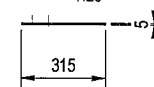

Vedere din fata 1:20

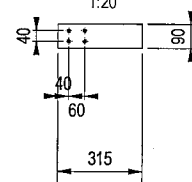

3D
Scara: 1:20

Vedere de jos 1:20

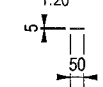

Vedere din fata 1:20

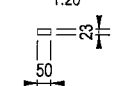

3D

Scara: 1:20

Vedere de sus 1:20

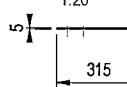

Vedere de sus 1:20

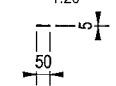

Vedere din spate 1:20

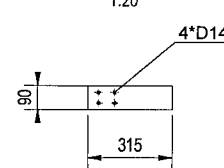

Vedere din spate 1:20

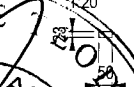

Vedere de sus 1:20

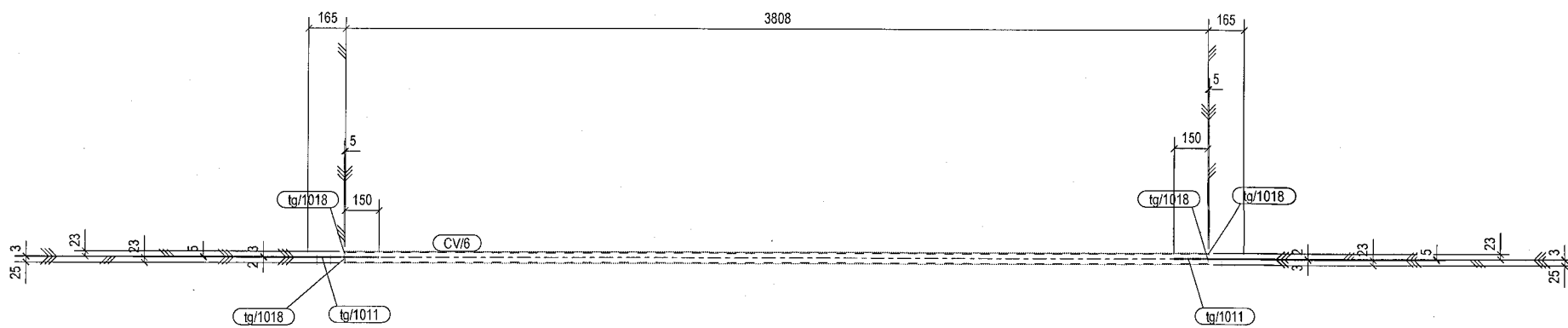

3D

Scara: 1:50

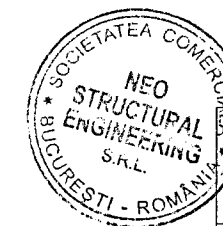
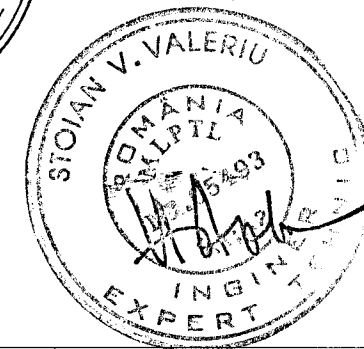
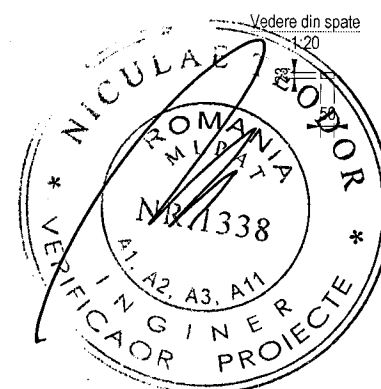
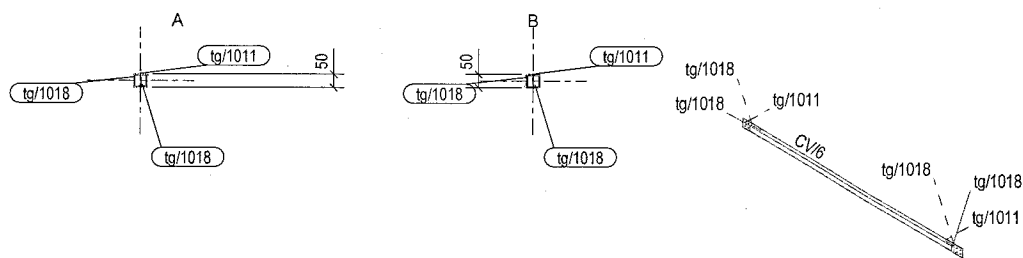

Neo
STRUCTURAL
ENGINEERING
S.R.L.

Proiectant structura:
SC NEO STRUCTURAL
ENGINEERING SRL
consultanta, proiectare, expertizare
structurii civile si industriale
Adresa: Cotza Veche, Nr. 4, M3/A, et. 1, 16, Sec. 1 Bucuresti

NOTE GENERALE: Suduri in relief cu grosimea de cordon de 0.7*t daca nu se specifica altfel.
Nivel B de acceptare a sudurilor. Sudura pe toata suprafata de contact.

EXTRAS DE LAMINATE PT. ANSAMBLUL: CVV/4 1 BUC. NECESARE						
Pozitie	Profil	Material	No.	Lungime	Arie	Greutate
CV/6	CFRHS50X50X4	S235JR	1	3808	0.7	20.8
tg/1011	PL5*90	S235JR	2	315	0.1	1.1
tg/1018	PL5*23	S235JR	4	50	0.0	0.0
Total					0.8	23.2

Denumire proiect: Modernizarea si realizarea energiei a Centralii de pregatire si rafinare/recuperare a capacitati de munca Diana

Beneficiar: MINISTERUL AFACERILOR INTERNE
Adresa: Judet Constanta, mun. Mangalia, statiunea Saturn, strada Greenpeace, Nr. 120, NCI

Sef proiect: Ing. Burciu Stefan
Proiectat: Ing. Burciu Stefan
Desenat: Ing. Ardelean Adrian

Denumire plansa: Ansamblul [CVV.4]

Scara: 1:20 1:50
Rev.: 0 Data: [CVV.4]