

Vedere de sus 1:20

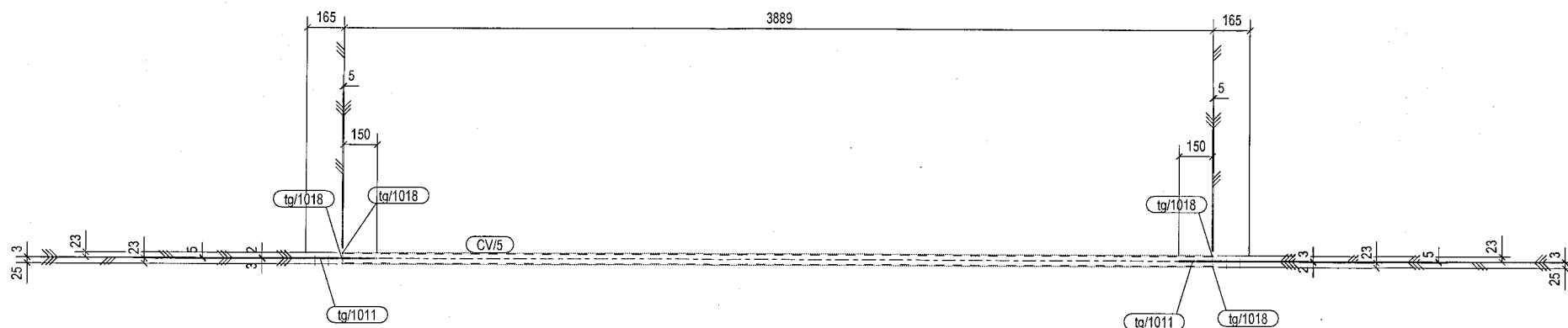

Vedere din fata 1:20

Vedere de jos 1:20

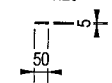

Vedere din fata 1:20

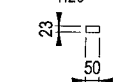

Vedere de sus 1:20

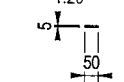

Vedere din spate 1:20

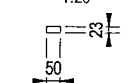

Vedere de jos 1:20

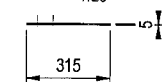

Vedere din fata 1:20

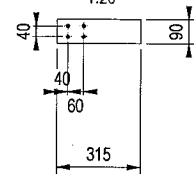

Vedere de sus 1:20

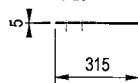

3D  
Scara: 1:20

3D  
Scara: 1:20

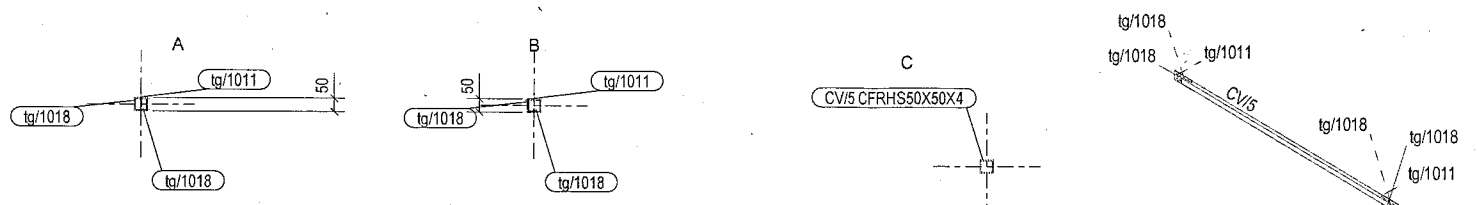

3D  
Scara: 1:50

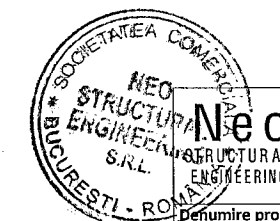
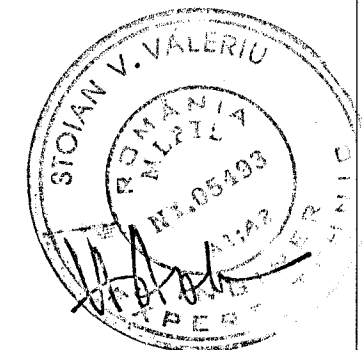
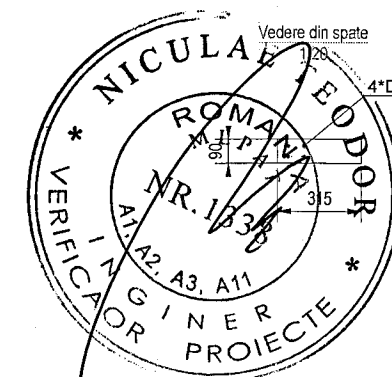

NeO  
SC NEO STRUCTURAL  
ENGINEERING S.R.L.

Proiectant structura:  
SC NEO STRUCTURAL  
ENGINEERING SRL  
consultanta, proiectare, expertizare  
structuri civile si industriale  
Adresa: Graba Verde, Nr.4, M3A, et. 3, P. 15, Sc. A, Bucuresti

Denumire proiect:  
Modernizarea si reabilitarea energetica a Centrului de pregatire si  
reabilitare a capacitati de munca Diana  
Nr. proiect:  
03/2025  
faza: P.T

Beneficiar: MINISTERUL AFACERILOR INTERNE  
Adresa: Judet Constanta, mun. Mangalia, statiunea Saturn, strada Gresiului, 2-3D, NC1

Sef proiect: Ing. Burciu Stefan  
Proiectat: Ing. Burciu Stefan

Desenat: Ing. Ardelean Adrian  
Denumire plansa: Ansamblul  
Camera Pompe

[CVV.3]  
Scara: 1:20 1:50  
Rev.: 0 Data: [CVV.3]

NOTE GENERALE: Suduri in relief cu grosimea de cordon de 0.7\*t daca nu se specifica altfel.  
Nivel B de acceptare a sudurilor. Sudura pe toata suprafata de contact.

EXTRAS DE LAMINATE PT. ANSAMBLUL: CVV/3 2 BUC. NECESARE

Pozitie	Profil	Material	No.	Lungime	Arie	Greutate
CV/5	CFRHS50X50X4	S235JR	1	3889	0.7	21.2
tg/1011	PL5*90	S235JR	2	315	0.1	1.1
tg/1018	PL5*23	S235JR	4	50	0.0	0.0
Total					0.9	23.6